

### State of Wyoming Corner Record

(In compliance with the *CORNER PERPETUATION AND FILING ACT*, Wyoming Statutes, 1977, Section 36-11-101, et, seq., and the Rules and Regulations of the Board of Registration for Professional Engineers and Professional Land Surveyors)

Reverse side of this form may be used if more space is needed.

Record of original survey and citation of source of historical information (if corner is lost or obliterated). Description of corner monumentation evidence found and/or monument and accessories established to perpetuate the location of this corner. Sketch of relative location of monument, accessories, and reference points with course and distance to adjacent corner(s) (if determined in this survey). Method and rationale for reestablishment of lost or obliterated corner.

GLO North between Sections 3 and 4 - intersect North boundary 79.56 chains, at 95 links West of Corner for Section 3 and Section 4 - S0°41'W on a true line 39.56 chains - set 18"x8"x8" granite boulder.

Found granite boulder 18"x8"x8" well set with a 1/4 carved thereon, perpetuated with a rebar and al. cap on the N. side as shown hereon.

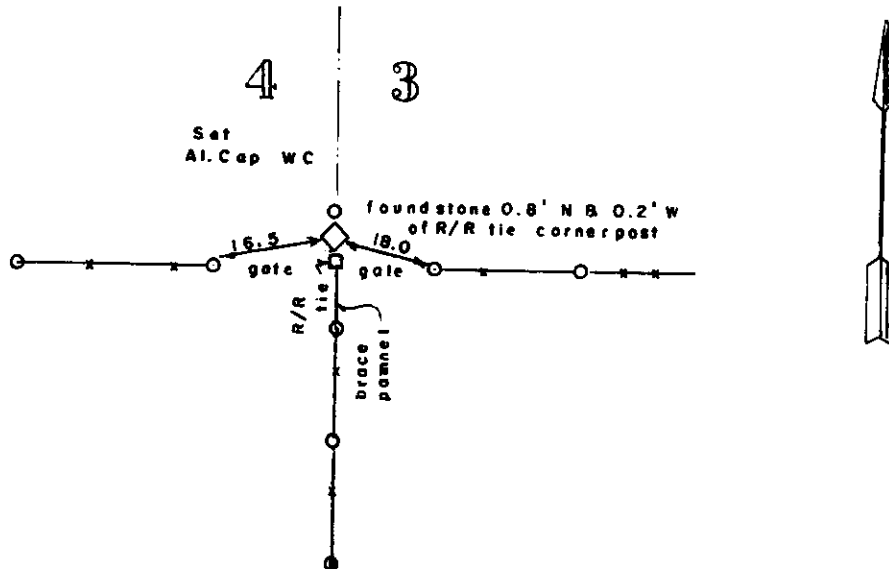

160349

LARRY T. PORTER  
Professional Land Surveyor

1995 APR 10 AM 9:08

Date of Field Work: 1 April 1995 Office Reference: \_\_\_\_\_

#### CROSS INDEX DIAGRAM

Firm/Agency, Address

Terrestrial Surveying & Mapping

P. O. Box 82

Cheyenne, WY 82003

Telephone Number: 634-9360

This corner record was prepared by me or under my direction and supervision.

SEAL & SIGNATURE

	1	2	3	4	5	6	7	8	9	10	11	12	13	14	15	16	17	18	19	20	21	22	23	24	25
A																									
B																									
C																									
D																									
E																									
F																									
G																									
H																									
J																									
K																									
L																									
M																									
N																									
O																									
P																									
Q																									
R																									
S																									
T																									
U																									
V																									
W																									
X																									
Y																									
Z																									

LARRY T. PORTER  
 2047  
 APR 10 1995  
 WYOMING

Corner Name: 1/4 Section: 4/3 T14 N R65W : 6th P.M. Cross-Index No.: C-13